

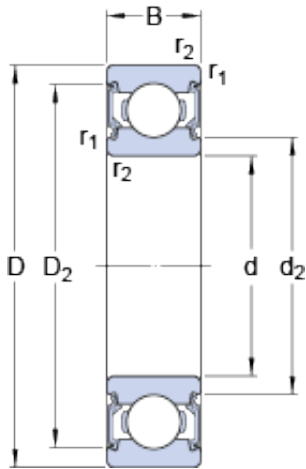

# INA BRAINGS SALES JAPAN CO.,LTD.



626-2rs1 Bearing 2D drawings and 3D CAD models

SKF 626-2rs1 \* 626-Rsl \* 626-Z \* 626-2z \* Ee 2  
 Tn9 Eeb 2-2z 618/7 628/7-2z 619/7-2z 619/7 607 \*  
 607-2z \* 607-Z \* 607-Rsl \* Deep Groove Ball  
 Bearing

Bearing No. 626-2rs1

Size	19x6x6 mm
Bore Diameter	19 mm
Outer Diameter	6 mm
Width	6 mm
d	6 mm
D	19 mm
B	6 mm
d <sub>2</sub>	9.5 mm
D <sub>2</sub>	16.5 mm
r <sub>1,2</sub> - min.	0.3 mm
d <sub>a</sub> - min.	8.4 mm
d <sub>a</sub> - max.	9.4 mm
D <sub>a</sub> - max.	16.6 mm
r <sub>a</sub> - max.	0.3 mm
Basic dynamic load rating - C	2.3 kN
Basic static load rating - C <sub>0</sub>	0.95 kN
Fatigue load limit - P <sub>u</sub>	0.04 kN
Reference speed	80000 r/min
Limiting speed	40000 r/min
Calculation factor - k <sub>r</sub>	0.025
Calculation factor - f <sub>0</sub>	13
Category	Single Row Ball Bearings



## INA BRAINGS SALES JAPAN CO.,LTD.

Inventory	0.0
Manufacturer Name	SKF
Minimum Buy Quantity	N/A
Weight / Kilogram	0.01
EAN	7316571839950
Product Group	B00308
Enclosure	2 Seals
Precision Class	ABEC 1   ISO P0
Maximum Capacity / Filling Slot	No
Rolling Element	Ball Bearing
Snap Ring	No
Internal Special Features	No
Cage Material	Steel
Enclosure Type	Contact Seal
Internal Clearance	C0-Medium
Inch - Metric	Metric
Long Description	6MM Bore; 19MM Outside Diameter; 6MM Outer Race Width; 2 Seals; Ball Bearing; ABEC 1   ISO P0; No Filling Slot; No Snap Ring; No Internal Special Features; C0-Medium Internal Clearance; Steel Cage; Co
Other Features	Deep Groove   Low Friction   NBR Seal
Category	Single Row Ball Bearing
UNSPSC	31171504
Harmonized Tariff Code	8482.10.50.68
Noun	Bearing
Keyword String	Ball
Manufacturer URL	<a href="http://www.skf.com">http://www.skf.com</a>
Manufacturer Item Number	626-2RSL
Weight / LBS	0.0227



## INA BRAINGS SALES JAPAN CO.,LTD.

Inner Race Width	0 Inch   0 Millimeter
Outer Race Width	0.236 Inch   6 Millimeter
Outside Diameter	0.748 Inch   19 Millimeter
Bore	0.236 Inch   6 Millimeter
bore diameter:	6 mm
static load capacity:	0.95 kN
outside diameter:	19 mm
finish/coating:	Uncoated
overall width:	6 mm
bearing material:	Steel
bore type:	Round
cage material:	Steel
closure type:	Double Sealed
fillet radius:	0.3 mm
row type & fill slot:	Single Row Non-Fill Slot
maximum rpm:	80000 rpm
snap ring included:	Without Snap Ring
weight:	0.018 lb
operating temperature range:	-40 to 212 ° F ° F
manufacturer product page:	<a href="#">Click here</a>
dynamic load capacity:	2.34 kN
manufacturer upc number:	7316571839950
$d_2$	9.5 mm
$D_2$	16.5 mm
$d_a$ min.	8.4 mm
$d_a$ max.	9.4 mm
$D_a$ max.	16.6 mm
$r_a$ max.	0.3 mm
Basic dynamic load rating C	2.34 kN
Basic static load rating $C_0$	0.95 kN
Fatigue load limit $P_u$	0.04 kN
Calculation factor $k_r$	0.025



## INA BRAINGS SALES JAPAN CO.,LTD.

Calculation factor $f_0$	13
Mass bearing	0.0083 kg