

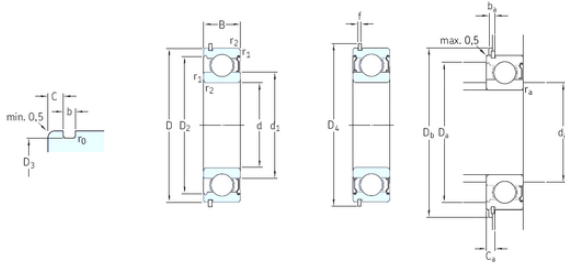

INA BRAINGS SALES JAPAN CO.,LTD.



65 mm x 140 mm x 33 mm SKF 6313-2ZNR deep groove ball bearings

Bearing No. 6313-2ZNR

6313-2ZNR Bearing 2D drawings and 3D CAD models

Size	65x140x33 mm
Bore Diameter	65 mm
Outer Diameter	140 mm
Width	33 mm
d	65 mm
D	140 mm
B	33 mm
C	33 mm
b	3,1 mm
d1	88,3 mm
f	2,82 mm
r0 max.	0,6 mm
r1 min.	2,1 mm
r2 min.	2,1 mm
C	4,9 mm
D2	122 mm
D3	135,23 mm
D4	149,7 mm
ba min.	7,72 mm
Ca max.	7,72 mm
da min.	3,5 mm
da max	88,3 mm
Da max.	128 mm
Db min.	151 mm
ra max.	2 mm



INA BRAINGS SALES JAPAN CO.,LTD.

Weight	2,2 Kg
Basic dynamic load rating (C)	97,5 kN
Basic static load rating (C0)	60 kN
Fatigue load limit (Pu)	2,5
Reference speed	10000 r/min
Limiting speed	6700 r/min
Calculation factor (f0)	13
Category	Single Row Ball Bearings
Inventory	0.0
Manufacturer Name	SKF
Minimum Buy Quantity	N/A
Weight / Kilogram	0
EAN	7316575550127
Product Group	B00308
Enclosure	2 Metal Shields
Precision Class	ABEC 1 ISO P0
Maximum Capacity / Filling Slot	No
Rolling Element	Ball Bearing
Snap Ring	Yes
Internal Special Features	No
Cage Material	Steel
Internal Clearance	C0-Medium
Inch - Metric	Metric
Long Description	65MM Bore; 140MM Outside Diameter; 33MM Outer Race Width; 2 Metal Shields; Ball Bearing; ABEC 1 ISO P0; No Filling Slot; Yes Snap Ring; No Internal Special Features; C0-Medium Internal Clearance; St
Other Features	Deep Groove With Snap Ring



INA BRAINGS SALES JAPAN CO.,LTD.

Category	Single Row Ball Bearing
UNSPSC	31171504
Harmonized Tariff Code	8482.10.50.68
Noun	Bearing
Keyword String	Ball
Manufacturer URL	http://www.skf.com
Weight / LBS	4.885
Outer Race Width	1.299 Inch 33 Millimeter
Inner Race Width	0 Inch 0 Millimeter
Outside Diameter	5.512 Inch 140 Millimeter
Bore	2.559 Inch 65 Millimeter
d_1	88.35 mm
D_2	121.3 mm
D_3	135.23 mm
D_4	149.7 mm
r_0 max.	0.6 mm
$r_{1,2}$ min.	2.1 mm
d_a min.	77 mm
d_a max.	88.3 mm
D_a max.	128 mm
D_b min.	151 mm
b_a min.	3.5 mm
C_a max.	7.72 mm
r_a max.	2 mm
Basic dynamic load rating C	97.5 kN
Basic static load rating C_0	60 kN
Fatigue load limit P_u	2.5 kN
Calculation factor k_r	0.03
Calculation factor f_0	13.2
Mass bearing	2.23 kg
Snap ring	SP 140